

PCS250G Communicator Module V2.12



The Vital Link

Reference and Installation Manual

PCS250G-EI03
Printed in Canada - 11/2014

P ▲ R ▲ D O X™

Table of Contents

Introduction.....	4
Features	4
Overview	6
System Components	6
LED Feedback	7
SIM Card Functionality	8
Tamper Switch Functionality	8
Specifications	9
Connections	10
SIM Card Connection	10
GSM vs. GPRS Connections	12
Communication Bridge	13
UC300 Connection	14
Optional Power Supply Connections	15
Using an External Power Input	15
VDMP3 Connection (Optional - GSM mode only)	15
Using an RS485 Link (GSM mode only)	16
Installation	18
Antenna Extension Installation (Optional)	18
Module Installation	18
Configuring the PCS250	19
Frequency Band	19
Bandwidth Saver Mode	19
SMS Forwarding	19
Configuring GSM Network Provider Information	20
Configuring Babyware Access	22
Programming GSM Reporting Options	22
Programming and Registering GPRS Reporting Options	23
SMS Backup Reporting	25
Configuring the PCS250 for SMS Backup Reporting	25
Troubles	27
Text message notification	28
SMS Language	28
Arm/Disarm System via Text Message	29
List of SMS Commands	29
Upload/Download	32
Public Network (GPRS mode only)	32
Private Network	33
Module Supervision	34
End User SMS Programming	35
View GSM IP Information	36
Text Messages	38

Chapter 1: Introduction

The PCS250G GPRS Communicator Module, leverages the GPRS data channel to provide wireless communication solutions for Paradox control panels. It offers reliable and fast communication between properties and their respective monitoring stations, the PCS250G is the vital link that keeps you connected.

Using cellular networks, the PCS250G reports to the monitoring station's automation software via GPRS, ensuring that all communication is fast, reliable, and stable. The PCS250G can be used as a backup to a traditional land line, or as a primary communicator where no land line is available. It also adds remote home control capabilities to a system, allowing you to arm/disarm with a simple text message (SMS). Feel safe by taking control of your system, wherever you are.

With its contemporary design, and a modern hi-tech finish, the PCS250G GPRS Communicator Module enables Paradox systems to be remotely controlled, continuously monitored, and reliably connected at all times.

Features

- Compact, sleek design
- Instant notification of panel supervision loss
- Easily arm/disarm the system via SMS (this feature is not available when using the UC300 Universal Converter)
- Report alarms by text messages to up to 16 cellular phone numbers
- Simple installation with 4-wire serial connection
- Supports 2 GSM provider SIM cards for provider redundancy
- Tamper switch support
- Optional rod antenna can be installed up to 18m (60ft) from the module using optional antenna cable extensions depending on the local signal strength
- Messages are secured with 128-bit (MD5) and 256-bit (AES) encryption
- Certification: EN 50136 ATS 5 Class II

In the Box

- PCS250G Communicator Module
- Standard Serial cable
- GPRS Module: pre-installed, may or may not support the optional antenna extension. Please see paradox.com for details.

Required/Optional Items

- Active SIM card (required)
- Second SIM card (required for provider redundancy - full backup for SIM Card 1)
- Antenna extension (optional for relevant GPRS module)
- 12 VDC external power supply (optional)
- Communication Cable to connect the PCS250G to an IP150 (if applicable)

Compatibility

- EVO192 panels V2.02 or higher
- EVOHD panel V1.0 or higher
- UC300 V1.0 or higher
- K641 and K641R keypads V1.51 or higher
- K641+ V1.0 or higher
- SP series V3.42 with K32LCD keypads V1.22
- MG series V4.0 or higher with K32LCD keypads V1.22 or higher
- IP150 Internet Module V1.2 or higher (requires Communication Cable, not included.)

For latest updates and more information, please visit paradox.com, or contact your local distributor.

Chapter 2: Overview

This section provides an overview of the Paradox PCS250G GPRS Communicator Module. It covers technical specifications, light-emitting diode (LED) functionality, and an overview of the PCS250G system components.

System Components

- 1) PCS250G motherboard
- 2) GPRS Module with dual SIM card slots
- 3) Optional MMCX male connector (for use with antenna)
- 4) InField upgrade connector
- 5) Power terminal
- 6) Captive screw
- 7) Serial cable connector
- 8) Tamper screw knockout hole
- 9) Tamper switch
- 10) System LEDs (refer to "LED Feedback" on page 7)

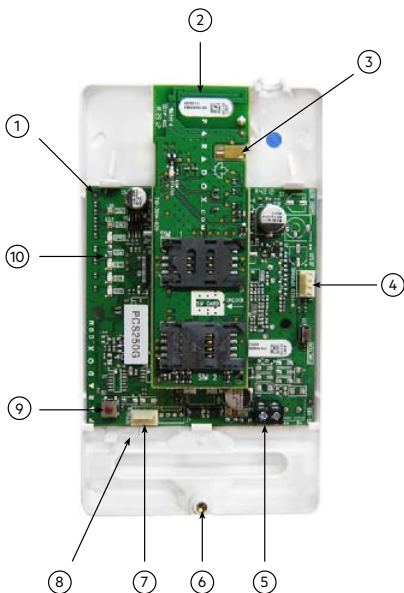

Figure 1: Inside the GPRS250G Module

LED Feedback

The following table provides a description of the PCS250G Communicator Module LEDs.

LED	Feedback
SIM Card 1	Solid green = SIM card 1 is installed on the GPRS Module Quick green flashing = SIM card 1 is exchanging data Slow green flashing = Searching the network Flash red (once) = SIM card 1 is defective Off = SIM card 1 is not installed, not active, or currently not in use
SIM Card 2	Solid green = SIM card 2 is installed on the GPRS Module Quick green flashing = SIM card 2 is exchanging data Slow green flashing = Searching the network Flash red (once) = SIM card 2 is defective Off = SIM card 2 is not installed, not active, or currently not in use
GPRS	Solid green = unit is set for GPRS operation Quick green flashing = exchanging data
GSM	Option not available on the PCS250G.
Signal Strength	LED 1, 2, and 3 (bottom three LEDs) indicate the strength of the incoming antenna signal.

Communication Loss

Upon loss of communication with the panel, the PCS250G LEDs will behave in the following manner:

- 1) GPRS LED displays is off; the SIM card and signal strength LEDs display their status for about 3 seconds.
- 2) Signal strength LED remains OFF; GPRS (green) is turned ON, followed in turn by SIM2 (orange) and SIM1 (red). When a LED is ON, all others are off. Each LED lights for about 200 ms. This sequence is repeated two times.
- 3) This cycle repeats until communication is restored.

SIM Card Functionality

The PCS250G provides dual SIM card support for provider redundancy. If a SIM card encounters network connectivity problems, the PCS250G will switch automatically to the other SIM card (only if installed). The PCS250G will then try to communicate and upon a successful communication, an SMS trouble message will be reported to the assigned recipients.

If connectivity problems occur on SIM card 1, the PCS250G will attempt to switch to SIM card 2. When successful, an SMS message will be sent to the assigned recipients informing them of the SIM card connectivity problem. If the panel is disarmed, the PCS250G will try to switch back to SIM card 1 after a 15 minute delay. If there is a connection problem on SIM card 1, it will retry to switch back to SIM card 1 every 15 minutes, or until the system is armed. If the system is armed, an attempt to switch back to SIM card 1 will occur only at midnight, otherwise SIM card 2 will remain the reporting channel until the system is disarmed. Detecting network connectivity problems on one SIM will result in a trouble message. Once the original SIM card connection is restored, a new SMS message will be sent to the assigned recipients informing them of the restore.

Note: *The SIM Card 2 functionality is the same as SIM Card 1. Both SIM cards must use the same communication method (both in GPRS mode).*

Tamper Switch Functionality

Upon removal of the PCS250G from its original installation surface, or if the PCS250G cover has been removed, a tamper switch open condition is recognized and is communicated to the control panel.

Note: If desired that the tamper switch activates upon removal of the PCS250G from its installation surface, a screw must be installed in the tamper screw hole, refer to "System Components" on page 6.

Once a "tamper switch open condition" has occurred, the control panel will generate an alarm (if armed), or send a trouble message to the keypad(s) (if disarmed). The control panel will also report a GPRS module tamper to the monitoring station and to SMS recipients assigned to receive trouble notifications.

Once the PCS250G's tamper switch is closed, the panel will reset the trouble message and a tamper restore message will be sent to the monitoring station and to the SMS recipients. Also, upon the closure of the PCS250G's tamper switch there is a 30s delay before the PCS250G sends out a "tamper close" status to the panel.

The PCS250G GPRS Communicator Module's tamper functionality is supported with a compatible Paradox control panel.

- MG/SP v4.90 and higher
- EVO192 v2.71 or higher
- EVOHD v1.0 or higher
- SP4000/SP65 v5.10 or higher
- IP150 v1.2 or higher
- UC300 v1.0 or higher

Specifications

The following table describes the technical specifications of the PCS250G GPRS Communicator Module.

Power	Class 4 (2W) @ 850/900 MHz Class 2 (1W) @ 1800/1900 MHz
Antenna	Gain <3dBi; impedance 50 Ohm Input power >2W peak power
Power Input	12 VDC nominal
Consumption	100 mA standby, average 450 mA (1.2 A peak) during GPRS transmission
Operating Temperature	0°C to 50°C (32°F to 122°F)
Encryption	128-bit (MD5 and RC4) or 256-bit (AES)
SMS Protocol	8-bit (ISO/IEC 8859-1) or 16-bit (UCS2 ISO/IEC10646)
Humidity	5-90%
Weight	200 g (7.05 oz)
Dimensions	17.2 x 9.8 x 4.4 cm (6.8 x 3.9 x 1.7 in.)
Certification	EN 50136 ATS 5 Class II

Chapter 3: Connections

The following section guides you through the steps required to connect the PCS250G prior to mounting the unit.

SIM Card Connection

The PCS250G connects to your Paradox control panel providing wireless communication capabilities to report system events to a IPR512 monitoring station, and/or to an IPRS-7 automation software installed on a PC. The PCS250G supports two standard GSM provider SIM cards. The SIM cards contains all your cellular telephone account information. In order to activate your SIM cards, you must contact your local GSM network provider.

Important: *If provider redundancy is not required (SIM card 2), ensure that SIM Card Tray 1 is used.*

Note: *Prior to setting up your PCS250G, it is important that the Personal Identification Number (PIN) of the SIM card be disabled. Refer to your cellular phone's manual for more information on how to disable the PIN.*

To install a SIM card:

- 1) Remove the front cover of the PCS250G Module. If the cover is not installed, proceed to Step 2.
- 2) Slide the SIM card tray towards the left to unlock it, and then flip the SIM card tray open, as shown in Figure 2.

Note: *Open the SIM tray slowly to avoid damage to the tray.*

- 3) Slide the SIM card into the tray with the cut-off corner towards the top right. Close the SIM card tray and slide the tray to the right to lock it into place.
- 4) Repeat steps 2 and 3 if you will be installing a secondary SIM card for provider redundancy.

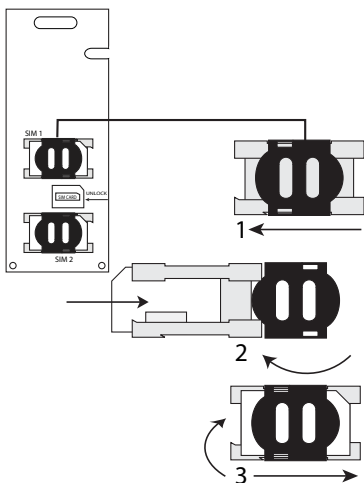

Figure 2: SIM Card Installation

GPRS Connections

The PCS250G is connected directly from the serial cable connector located on the bottom of the unit to the serial connector of the panel using the provided serial cable.

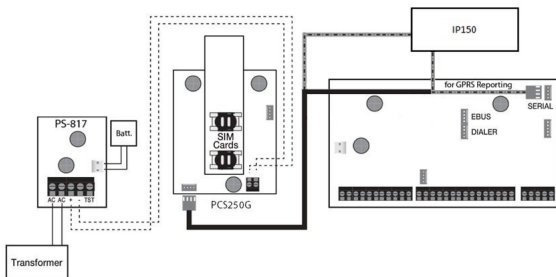

Figure 3: GPRS Serial Connections

Communication Bridge

When using a Communication Cable, the IP150 Internet Module and the PCS250G are interlinked to the control panel and communicate together to report alarms to the IP/GPRS monitoring receiver (IPRS-7 or IPR512). In the case of IP communication troubles, the PCS250G will automatically take over and report all system events to the respective monitoring station providing you reliable protection. This is all achieved between the control panel, reporting devices, and the monitoring receivers.

Follow the instructions below to interlink the IP150, PCS250G, and the control panel.

To interconnect the modules

1. Connect the micro connector side of the Communication cable to the PCS250G port of the IP150.
2. Connect the other side of the Communication Cable to the Serial port of the PCS250G.

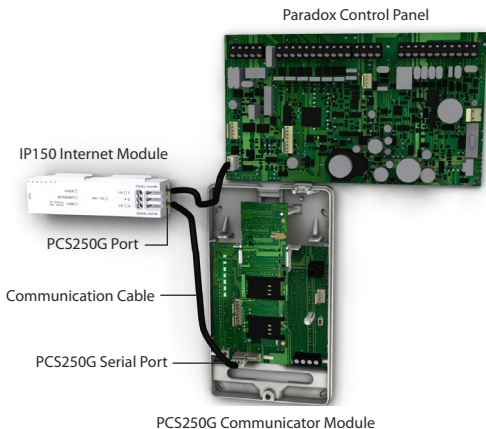

Figure 4: Interlinking Paradox Components

UC300 Connection

When using an UC300 Universal Converter to connect to third party alarm systems, the PCS250G and the UC300 must be connected and configured in order to report events and alarms via a Paradox IP receiver. The UC300 provides the link between CID control panel security systems and the PCS250G.

The UC300 converts Contact ID (CID) events generated by a security panel connected to a landline interface via paradox proprietary protocol. Events are then forwarded to the CMS by the PCS250G. For configuration details, please refer the UC300 Quick Start Guide. Follow the instructions to connect the PCS250G with the UC300.

To connect the modules

1. Connect the PCS250G cable between the UC300 serial port and the PCS250G serial port.
2. Connect the Tip and Ring from the UC300 to an outgoing telephone jack.
3. Connect the customer's control panel Tip and Ring to the UC300's T1 and R1 terminals.
4. Connect to the UC300 a 12 Vdc power supply to a supervised power supply.

Figure 1: Connecting the PCS250G to an UC300

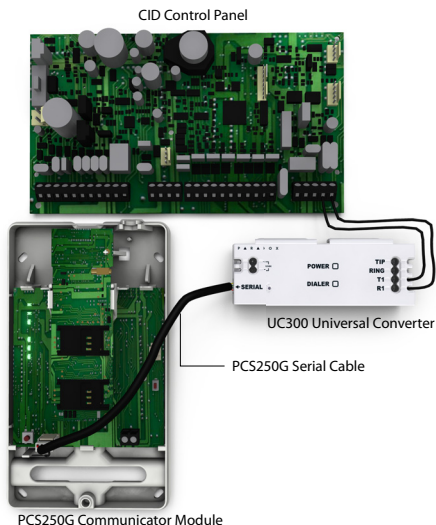

Optional Power Supply Connections

The PCS250G is designed to be powered by the control panel. However, if you want the PCS250G to function even if the control panel battery is low, or if power failures are anticipated, an external power supply with a backup battery (such as the PS817) can be used. For more information on connecting to an external power supply visit paradox.com.

Using an External Power Input

When an external power input is used as a backup power supply, the following connections are required:

- Screw 1 = +12V
- Screw 2 = ground

The maximum wire length for each of those power lines is as follows:

- 12m (40 ft.) for AWG24
- 20m (65 ft.) for AWG22
- 30m (100 ft.) for AWG20
- 50m (160 ft.) for AWG18

Chapter 4: Installation

The following section describes how to install the PCS250G module, and how to install the optional Antenna Extension.

Antenna Extension Installation (Optional)

If your GPS signal strength is weak, you may choose to add an antenna to improve reception. You may purchase a kit (called an ANTKIT from paradox.com) which provides an antenna, a mounting bracket, and a cable that connects from the GPRS module in the PCS250G, to a small antenna rod.



Figure 5: Antenna Extension

To Install the Antenna Extension:

- 1) Use the mounting bracket to mark the holes onto the mounting surface.
- 2) Drill the holes and insert the antenna extension in the bracket until it snaps into place.
- 3) Align the bracket and secure into place using the appropriate mounting hardware.

Note: *There are two knockout holes in the PCS250G enclosure. The one located at the top of the enclosure is used for an extension cable while the other one is used if an external antenna is installed on the box (rod antenna).*

Module Installation

The PCS250G must be securely mounted on a wall or similar surface. It is important to mount it as far away as possible from any electronic equipment. Ensure that it is mounted as high as possible to ensure protection from RF interference.

To mount the PCS250G:

- 1) Use the module as a template to mark the five holes onto the mountings surface (four mounting, one tamper).
- 2) Drill the holes.

- 3) Align the PCS250G and secure into place using the appropriate hardware, as shown in Figure 6.

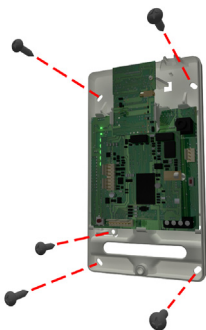

Figure 6: Mounting the Module

Chapter 5: Configuring the PCS250G

In order for the unit to provide GPRS reporting, certain configurations must be set. These configurations include configuring GSM network provider information, configuring the PCS250G for BabyWare access, and registering and programming GPRS reporting options. Configuration can be done via keypad/touchpad, SMS commands or BabyWare application.

Frequency Band

The PCS250G will automatically be set to a working frequency according to your country.

Bandwidth Saver Mode

The PCS250G can turn off SIM card usage during system inactivity until a new event is sent from the panel. The bandwidth saver mode can be turned ON or OFF by sending the following SMS message to the PCS250G.

P[admin].BWS.[value]

e.g., Padmin.BWS.on

Where [admin] is the PCS250G default password (if the password has been changed, enter in the new password) and [value] is either ON or OFF to enable or disable bandwidth saver mode.

Note: *The bandwidth saver mode is turned ON by default.*

SMS Forwarding

Communicating Using Text Messages

The PCS250G is capable of sending and receiving SMS text messages.

The PCS250G allows you to program up to 8 phone numbers:

- Supports the programming of multiple SMS forwarding phone numbers.
- If an SMS forwarding number is programmed, there are 7 programmable phone numbers remaining that can send text messages.
- If NO SMS forwarding number is programmed, there are 8 programmable phone numbers remaining send text messages.

Consult your installer for more information.

Programming Phone Numbers At The Panel

To program your PCS250G to forward all SMS coming in from a specific number, simply add the letter "P" in front of the phone number you program through the panel:

- You would program (**P**5145551234) to **forward**
- You would program (5145551234) to **send** text messages

Note: If you are connected to an UC300 Universal Converter, please use BabyWare to program phone numbers.

Forwarding SMS Text Messages

To forward SMS text messages (received by your system) you need to:

- Program the 1 telephone number that sends text notifications to your system.
- Select "trouble" event group to forward SMS text messages.
- All messages from this phone number will automatically be forwarded to the remaining phone numbers programmed to receive text messages and select trouble event groups from the system.

Note: If you are connected to an UC300 Universal Converter, please use BabyWare to program phone numbers.

Receiving Text Messages

To receive text messages from your system you need to:

- Program the telephone numbers you wish to receive text notifications.
- Select which event groups (alarm, arm/disarm, trouble and trouble restore) will generate text messages.
- Select which partition the phone number is assigned to. Please note that this does not apply if you are connected to an UC300 Universal Converter.

Configuring GSM Network Provider Information

To connect the PCS250G to the GPRS network, certain registration parameters must be set (supplied by your GSM network provider). These parameters include the Access Point Name, APN User Name, and the APN Password. You can program this information via your control panel (if connected to an UC300 program both SIM cards via BabyWare) or via an SMS command (SIM card 2 can only programmed via an SMS command). To begin the configuration of your GSM network provider information via a control panel, enter the section programming in your panel.

MG/SP/E	EVO	Feature
[921]	[2960]	APN part 1 (characters 1 - 16)
[922]	[2961]	APN part 2 (characters 17 - 32)
[923]	[2962]	APN user name part 1
[924]	[2963]	APN user name part 2
[925]	[2964]	APN password part 1
[926]	[2965]	APN password part 2
IMPORTANT: This information can be obtained from your GSM network provider.		

Note: When entering into GSM network provider sections, the LCD screen of the control panel's keypad will display either "Labels" or "Messages".

To configure your GSM network provider information via an SMS command, enter the following SMS commands.

Important: SIM card 2 can only be programmed via SMS. The SMS needs to be sent to SIM card 1 in order to program SIM card 2. When connected to an UC300 Universal Converter, both SIM cards are programmed via BabyWare.

P[password].APN1.NAME.[Access Point Name]	Used to program the SIM card 1 Access Point Name
P[password].APN1.USER.[Access Point Name]	Used to program the SIM card 1 Access Point User
P[password].APN1.PSW.[Access Point Name]	Used to program the SIM card 1 Access Point Password
P[password].APN1.CLEAR	Used to clear the SIM card 1 Access Point Name
P[password].VAPN1.[CALL BACK PHONE NUMBER]	Used to view the SIM card 1 Access Point Name information

Note: When programming the second SIM card, replace APN1 with APN2 and VAPN1 with VAPN2 in the SMS command. Refer to "List of SMS Commands" on page 27 to view the commands for SIM card 2.

Configuring BabyWare Access

The PCS250G GPRS Communicator Module provides remote access for upload and download with BabyWare via a GPRS connection. The following site specific sections must be configured for BabyWare access.

Note: In the case where a reportable event occurs while a BabyWare session is active via GPRS, the communication is terminated to allow event reporting.

MG/SP/E	EVO	Feature	Details
[920]	[2966]	Software port	Default: 10000
[927]	[3013]	Password	Default: admin

Programming and Registering GPRS Reporting Options

The following sections describe the options that must be programmed in the panel for GPRS reporting. If you are using an UC300 Universal Converter, please program GMS reporting options via BabyWare.

MG/SP/E	EVO	Feature	Details
[918] [919]	[2976] to [2983]	Account / partition registration	MG/SP/E: sections represent account / partition 1 & 2 EVO: sections represent account / partition 1 to 8
[806]	[2975]	[7] Off + [8] Off = Landline only [7] Off + [8] On = GPRS primary / landline backup (default) [7] On + [8] Off = Landline only [7] On + [8] On = Landline & GPRS in parallel	

Receiver Settings	MG/SP/E			
Receiver #:	1	2	Backup	
IP address*	[929]	[936]	[943]	
IP port**	[930]	[937]	[944]	
IP address WAN2	[931]	[938]	[945]	
IP port WAN2	[932]	[939]	[946]	
Receiver password [†]	[933]	[940]	[947]	
Security profile	[934]	[941]	[948]	
Module registration - press [ARM] to register	[935]	[942]	[949]	
Receiver Settings	EVO			
Receiver #:	1	2	3	4
IP address*	[2984]	[2986]	[2988]	[2990]
IP port**				
IP address WAN2				
IP port WAN2				
Receiver password [†]				
Security profile				
Module registration - press [ARM] to register	[2985]	[2987]	[2989]	[2991]

* For 1 or 2 digit numbers, add "0s" before the digit: e.g., 138.002.043.006

** Default 10000

[†] Enter [MEM] for blank space

Note: When entering into Receiver Settings sections, the LCD screen of the control panel's keypad will display "Data" for the receiver password and security profiles sections.

SMS Backup Reporting

The PCS250G GPRS Communicator Module supports SMS backup reporting to an IPRS-7 (IP/GPRS PC Receiver Software) when used in conjunction with a compatible Paradox control panel.

- SP5500/SP6000/SP7000 v4.76
- EVO192 v2.65
- SP4000/SP65 v4.94

This advanced feature assures continuous communication with the protected premises. With the addition of a GSM/GPRS modem (required), the IPRS-7 software will be able to receive alarm signals through SMS text messages when GPRS communication is disrupted. Should the GPRS channel fail to transmit from a protected premise because of a power outage or internet failure, a backup SMS will automatically be sent to the IPRS-7 (containing the same CID information of the reportable event).

Note: This feature is not available if your PCS250G is connected an UC300 Universal Converter.

Configuring the PCS250G for SMS Backup Reporting

Enter the following command to program the receiver's SMS parameters:

- 1) Send the SMS command:
P[PASSWORD].SMS.[GSM MODEM TELEPHONE #].[IPRS-7 PASSWORD] (e.g., Padmin.SMS.5145551111.123456)
- 2) Wait two minutes. The PCS250G will automatically register to the IPRS-7 receiver. This will automatically program the Backup IP receiver, IP address, port and port as follows:

IP address = 000.000.000.001

IP password = IPRS7 password

Port number = 00001

Backup IP receiver section reference:

Control Panel	IP address	Port	Password	Register IP/GPRS module
SP Series	[943]	[944]	[947]	[949]
EVO Series (IP Receiver #4)	[2990]			[2991]

Enter the following command to view the SMS reporting settings (VSMS):

- 1) Send the VSMS command:
P[PASSWORD].VSMS.[CALLBACK PHONE NUMBER]
(e.g., Padmin.VSMS.5145552222)
- 2) If the SMS reporting parameters are programmed properly, the following SMS will be received:
SMS#: [GSM modem telephone # (5145551111)]
Password: [IPRS-7 password (123456)]
Status: [IPRS-7 registration status]
- 3) If nothing is programmed or the programmed information has been cleared, the following SMS will be received:
[SMS #: SMS receiver not programmed]

Enter the following command to clear the programmed SMS parameters:

- **P[password].SMS.CLEAR**

SMS commands reference:

SMS - Program the receiver's SMS parameters	P[password].SMS.[GSM modem telephone #].[IPRS-7 password]
VSMS - View the SMS reporting settings	P[password].VSMS.[callback phone number]
Clearing the programmed SMS parameters	P[password].SMS.clear

Note: If SMS registration fails, you can use registration section (SP Series [949], EVO Series [2991]) to restart the SMS registration process on the backup receiver.

Troubles

The following sections and options have been added to support the IPR512 GPRS/IP Monitoring Receiver.

MG/SP/E Trouble Group	MG/SP/E Trouble Sub-Group
[4] Communication Trouble	[7] Fail to communicate with receiver [9] GSM network failure [OFF] IP Receiver unregistered (IP/GPRS)
[6] Trouble	[6] Tamper trouble
[10] Module supervision loss	[9] GPRS/GSM module
EVO Trouble Group	EVO Trouble Sub-Group
[9] Communication Trouble	[2] Tamper trouble [5] Fail to communicate with receiver 1 [6] Fail to communicate with receiver 2 [7] Fail to communicate with receiver 3 [8] Fail to communicate with receiver 4 [9] IP Receiver unregistered (IP/GPRS)

Note: If your PCS250G is connected to an UC300, system troubles can only be viewed via BabyWare.

Text Message Notification

In addition to reporting control panel events via a GSM cell phone network through GPRS, the PCS250G can also send text messages (SMS) to the end user (up to 16 cell phone numbers). The PCS250G can send text messages for any control panel event due to its proprietary communication through the panel's serial port. Each text message contains a detailed description of the event including date and time and any associated labels such as zone and serial number. The detailed description of each system event is pre-programmed and hard coded into the PCS250G. If your PCS250G is connected to an UC300, this can be configured via BabyWare.

MG/SP/E	EVO	Feature	Details
[856]	[2953]	SMS language	Values: 000-255 (see SMS Language)

SMS Language

Language	Value	Language	Value
English*	000	Bulgarian	016
French	001	Romanian	017
Spanish	002	Slovak	018
Italian	003	Chinese	019
Swedish	004	Serbian	020
Polish	005	Malay	021
Portuguese	006	Slovenian	022
German	007	Lithuanian	023
Turkish	008	Finnish	024
Hungarian	009	Estonian	025
Czech	010	French Canadian	026
Dutch	011	Belgian	027
Croatian	012	Latvian	028
Greek	013	Albanian	029
Hebrew	014	Macedonian	030
Russian	015		
*Default Value = 000			

Note: Some languages are not currently supported. If an unsupported language is selected, messages will be sent in English. Some languages, like Hungarian or Romanian, will generate two SMS messages per event reported and other languages will use special LCD characters not supported on all cell phones. Refer to the paradox.com website for the list of languages that are supported, that generate two SMS messages, or that use special characters. Refer to the control panel programming guide for information about entering special characters.

Arm/Disarm System via Text Message

It is possible to arm or disarm your system by sending an SMS text message from any cell phone. The message must be sent to the PCS250G's phone number, as determined by the cell phone network provider. This feature is not available if your PCS250 is connected to an UC300.

Note: *This feature takes seven minutes to activate after power up. You will need to wait seven minutes after a power-up or after a SIM card switch before this feature is available.*

The text message command has a specific format and specific elements that must be sent to the phone number of the PCS250G module. The format is as follows:

SMS Text Message Format

C[USER CODE].[ACTION].A[AREA].[PHONE NUMBER]

Examples

Arming - C1234.ARM.A5.5555551234

Disarming - C1234.OFF.A5.5555551234

Multiple partitions - C1234.ARM.A1,3,5TO7.5555551234

List of SMS Commands

The following table provides a listing of all SMS commands. If you are connected to an UC300, not all commands are available. Please refer to the following table for more details.

Note: for EVO systems, the “password” is found in section [3013], and for MG/SP systems, the “password” is in section [927] under PCS Connections Settings.

P[password].A.[IP address].P[port number]	Used for GPRS remote access
P[password].IP.[call back phone number]	Used to obtain the IP address and IP port of the PCS250G and whether or not the “bandwidth saver” option is being used
P[password].RESET	Used to reset the PCS250G
P[password].BWS.ON	Used to enable bandwidth saver mode
P[password].BWS.OFF	Used to disable bandwidth saver mode
P[password].STATUS.[phone number] <i>*This command is not available with use of the UC300.</i>	Used to obtain the signal strength, signal quality, GPRS connection status, and APN settings of the current SIM card
P[password].APN1.NAME.[Access Point Name]	Used to program the SIM card 1 Access Point Name
P[password].APN1.USER.[Access Point Name]	Used to program the SIM card 1 APN User Name
P[password].APN1.PSW.[Access Point Name]	Used to program the SIM card 1 APN Password
P[password].APN1.CLEAR	Used to clear the SIM Card 1 Access Point Name
P[password].VAPN1.[CALL BACK PHONE NUMBER]	Used to view the SIM card 1 Access Point Name information
P[password].APN2.NAME.[Access Point Name]	Used to program the SIM card 2 Access Point Name
P[password].APN2.USER.[Access Point Name]	Used to program the SIM card 2 APN User Name
P[password].APN2.PSW.[Access Point Name]	Used to program the SIM card 2 APN Password

P[password].APN2.CLEAR	Used to clear the SIM card 2 Access Point Name
P[password].VAPN2.[CALL BACK PHONE NUMBER]	Used to view the SIM card 2 Access Point Name information
P[password].[IP1W1/ IP1W2/ IP2W1/ IP2W2/ IP3W1/ IP3W2/ IP4W1/ IP4W2].[domain name] <i>*This command is not available with use of the UC300.</i>	Set domain name for GPRS receiver
P[password].[IP1W1/ IP1W2/ IP2W1/ IP2W2/ IP3W1/ IP3W2/ IP4W1/ IP4W2].CLEAR <i>*This command is not available with use of the UC300.</i>	Clear domain name for GPRS receiver
P[password].DNS.[ip address] <i>*This command is not available with use of the UC300.</i>	Set domain name server (DNS) IP address
P[password].DNS.CLEAR <i>*This command is not available with use of the UC300.</i>	Clear domain name server (DNS) IP address
P[password].VIP.[phone number] <i>*This command is not available with use of the UC300.</i>	Get domain name server (DNS) info
C[user code].[ARM/OFF].A[area number], [area number], [area number]TO[area number] <i>*This command is not available with use of the UC300.</i>	Arm/Disarm area

Chapter 6: Upload/Download

Fast upload/download can be configured via BabyWare or NEware using a GPRS connection. Upload and download can be achieved on both public and private networks. To find out the type of provider network you are currently set up on, contact your local SIM card provider for more information.

Public Network

In order to connect to the GPRS network, you must verify the connection by receiving the IP address of the PCS250G GPRS Communicator Module. Before beginning any upload/download procedures you must ensure that the registration parameters of the PCS250G have been set.

Note: *It is important that the router used with the PCS250G application (BabyWare and NEware) has been set up for port forwarding to ensure proper system functionality.*

To receive the IP address of the PCS250G via text message you must use a cellular phone and enter:

P[TCP/IP password].IP.[phone number to answer back]
e.g., Padmin.IP.5551231234

The PCS250G will send a response to the specified phone number displaying the IP address of the module. This information must be entered into the BabyWare application. The IP address can then be used to configure remote software access.

Private Network

If your SIM card provider is on a private network, communication to the PCS250G must first be established via an SMS message. When the SMS message is sent to the PCS250G, the PCS250G will then initiate a connection with BabyWare. Once communication is established, firmware upgrades, as well as upload and download configurations and system programming can begin.

Important: *All firmware upgrades can only be conducted using the SIM1 socket.*

Before beginning any upload/download procedures you must ensure that the registration parameters of the PCS250G have been set.

Note: *It is important that the router used with the PCS250G application (BabyWare and NEware) has been set up for port forwarding to ensure proper PCS250G system functionality.*

To Initiate a GPRS Connection Request via SMS:

- 1) Launch BabyWare.
- 2) Log on to BabyWare by entering your **User** and **Password** information.
- 3) Double-click the account you wish to establish communication with from the Account Group list.
- 4) On the menu bar, click **System** and then click **Wait for call**.
- 5) Enter the SMS text information to be sent to the PCS250G as you see it on screen e.g., "Padmin.A10.10.1.100.P10001".

Chapter 7: Module Supervision

The PCS250G provides several supervision options to ensure that you or your monitoring station is notified of problems such as loss of GPRS service or loss of communication with the control panel.

Unique to Paradox, the PCS250G can supervise the presence of the control panel or the UC300 Universal Converter. If communication with the control panel is lost, the PCS250G will send an SMS message.

The PCS250G verifies the presence of the GSM cell phone network approximately every 20 seconds. If the connection is lost, the panel can generate an alarm or trouble after the delay has elapsed (programmed in section [2952] for EVO or [855] for MG/SP). When the GSM network connection is lost, the SIM card LED is no longer steady on.

MG/SP/E	EVO	MG/SP/E Details	EVO Details
[805]	[2950]	[5] Off + [6] Off = Module supervision disabled [5] Off + [6] On = Armed: generates a trouble (default) [5] On + [6] Off = Armed: generates an audible alarm [5] On + [6] On = Silent alarm becomes an audible alarm	[5] Off + [6] Off = Module supervision disabled [5] Off + [6] On = Armed: generates an audible alarm [5] On + [6] Off = Armed: generates a trouble (default) [5] On + [6] On = Silent alarm becomes an audible alarm
[855]	[2952]	Set the delay before a GSM No Service trouble is reported. (000 - 255 x 2 sec. / default: 016 (32 sec.)	

Important: It is highly recommended to set section (SP Series [885], EVO Series [2952]) at a higher value than 120 seconds (2 minutes) due to the latency of the GSM network.

End User SMS Programming

With Master Programming, you can:

- Set which phone numbers (up to 8 with MG/SP/ E-Series or 16 with Digiplex EVO, 8 with the UC300) will receive text messages sent by the PCS250G to report system events.
- Select from which area the PCS250G will send text messages (per phone number). This feature is not available when connected to an UC300.
- Select which event groups (alarm, arm/disarm, trouble and trouble restore) will generate text messages.

End User SMS Programming with Digiplex EVO

- 1) Enter the control panel [MASTER CODE] then press [0] to access Master Programming.
- 2) Press [1] to enter the SMS settings menu.
- 3) Select which phone number you wish to program ([01] to [16]).
- 4) Enter or modify the phone number - up to 32 characters. To go to the next screen press [ENTER].
- 5) Select which partitions are enabled for that SMS number by enabling options [1] to [8]. Press [ENTER] to go to the next screen.
- 6) To select which events generate an SMS message, enable or disable options [1] to [4].
- 7) To save press [ENTER].
- 8) After saving or in the main SMS settings menu press [▼] to see which SMS numbers ([01] to [16]) are programmed. To program the SMS number currently displayed, press [ACC].

End User SMS Programming with MG/SP / E-Series

- 1) To access Master Programming, press the [Ⓜ] key.
- 2) Enter [MASTER CODE].
- 3) To enter SMS Setup, press [ARM].
- 4) Using the [▲] and [▼]* or [STAY] keys, select one of the eight telephone numbers you wish to program and press [ENTER].
*With K10LEDV/H or K636 keypads, use [SLEEP] for [▲] and [STAY] for [▼].
- 5) Enter or modify the phone number - up to 32 characters. To go to the next screen press [ENTER].
- 6) Select the SMS Event Call Options you wish to apply to the telephone number.
- 7) To save press [ENTER].

- 8) Select which areas are assigned to this telephone number.
To save, press [ENTER].

SMS Phone Number Special Characters for EVO panels	
*	[stay]
#	[force]
+	[arm]
Other panels	
*	[off]
#	[bypass]
+	[mem]

Event Call Options	
Option	Events that send SMS
[1]	Any Alarm
[2]	Arming and Disarming
[3]	Any Trouble
[4]	Any Trouble Restore
[5] to [8]	Future Use

View GPRS IP Information

It is possible to view the following GPRS IP information in Master Programming:

- **IP Address:** Access this to determine which IP address to enter in the BabyWare or NEware GPRS connection settings. The IP address is determined automatically when the PCS250G connects to the GSM network. In order to properly read the IP address assigned, the GPRS LED must be on.
- **IP Port:** Access this to determine which IP port to enter in the BabyWare or NEware GPRS connection settings. This is the port that the module will listen for incoming GPRS communication. This port is programmed in section [2966] with Digiplex EVO or [920] with MG Series, SP Series, E-Series.
- **User PC Software Password:** This password is needed to connect to the control panel using the NEware software. This password is determined in the NEware software.

Viewing GPRS IP Information with Digiplex EVO

- 1) To access Master Programming, enter the [MASTER CODE] then press [0].
- 2) In Master Programming, press [2] to display the PCS250G IP information.
- 3) The first screen displays the PCS250G IP Address. Press [▼] to access the next screen.
- 4) The second screen displays the PCS250G IP Port. Press [▼] to access the third screen.
- 5) The third screen displays the PCS250G User PC Software Password. If you press [▼] again, the Exit Message will be displayed.

Viewing GPRS IP Information with MG/SP / E-Series

- 1) Press the [] key.
- 2) Enter [MASTER CODE].
- 3) To enter SMS Setup, press [ARM].
- 4) Using the [▲] key, scroll up to [9] GSM IP Address and press [ENTER]. To return to the GSM menu, press [ENTER].
- 5) Using the [▲] key, scroll up to [10] GSM IP Port and press [ENTER]. To return to the GSM menu, press [ENTER].
- 6) Using the [▲] key, scroll up to [11] GSM PC Password (Future use). To return to the GSM menu, press [ENTER].
- 7) Using the [▲] key, scroll up to [12] Site Name. To return to the GSM menu, press [ENTER].
- 8) To exit the GSM menu, press [CLEAR].

Chapter 8: Text Messages

The following table lists all pre-defined text messages that can be sent. These messages follow the 8-bit or 16-bit SMS protocol and include the elements from the information column. The messages will also use the labels programmed in the system for the area name, zone name, user name, and module name.

Alarm Messages

Message	Information*
Alarm cancelled	1-2-3
Alarm cancelled with remote	1-2-3
Alarm cancelled through Internet	1-2-3
Alarm cancelled through End-User PC Software	1-2-3
Alarm cancelled through Voice Module (Phone)	1-2-3
Alarm cancelled through SMS	1-2-3
Alarm cancelled with keyswitch	1-2- 4
Alarm cancelled through Installer PC Software	1, 2
ALARM	1-2-3
FIRE ALARM	1-2-3
DURESS ALARM	1-2-3
PANIC ALARM	1-2-3
MEDICAL PANIC ALARM	1-2-3
FIRE PANIC ALARM	1-2-3
PARAMEDIC PANIC ALARM	1-2-3
GSM/GPRS module: Tamper Alarm	1

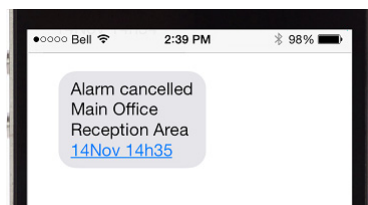

Information Index
1: Date and Time
2: Area Name
3: Zone / User /
Module Name
4: ID
5: Module Serial
Number

Arming/Disarming Messages

Message	Information*
Arming	1-2-3
Arming with remote	1-2-3
Arming through internet	1-2-3
Arming through end-user PC software	1-2-3
Arming through voice module (phone)	1-2-3
Arming through SMS	1-2-3
Arming with keyswitch	1-2- 4
Arming through Installer PC software	1-2
One-touch arming	1-2
Auto-arming	1-2
Disarming	1-2-3
Disarming with remote	1-2-3
Disarming through internet	1-2-3
Disarming through end-user PC software	1-2-3
Disarming through voice module (phone)	1-2-3
Disarming through SMS	1-2-3
Disarming with keyswitch	1-2- 4
Disarming through Installer PC software	1-2

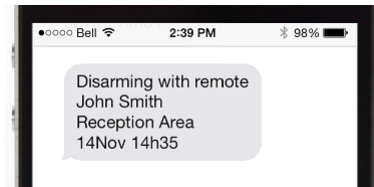

Information Index

- 1: Date and Time
- 2: Area Name
- 3: Zone / User / Module Name
- 4: ID
- 5: Module Serial Number

Trouble Event Messages

Message	Information*
AC power failure on control panel	1
Battery failure on control panel	1
Bell overload on control panel	1
Bell disconnected from control panel	1
Phone line trouble on control panel	1
Pager communication from control panel failed	1- 4
Central station communication from control panel failed	1- 4
Voice communication from control panel failed	1
Installer PC communication from control panel failed	1
Date and time loss on control panel	1
RF interference detected on system's wireless communication	1
Tamper trouble on module	1-3- 5
Phone line trouble on module	1-3- 5
Central station communication from module failed	1-3- 5
Printer module trouble	1-3- 5
AC power failure on bus or wireless module	1-3- 5
Battery failure on bus or wireless module	1-3- 5
Auxiliary power overload on bus or wireless module	1-3- 5
Missing module	1-3- 5
Tamper trouble on zone	1-2-3-5
Trouble on fire zone	1-2-3-5
Low battery on wireless zone	1-2-3-5
Missing wireless zone (supervision loss)	1-2-3-5
Auxiliary power overload on control panel	1
Communication with GSM network lost	1
GSM communication with control panel lost	1
GSM/GPRS module: Tamper Trouble	1
GSM/GPRS module: Please check inactive SIM card # connectivity	1
Trouble on module - direct light	1-3-5
Trouble on module - bus voltage trouble	1-3-5
Trouble on module - self-test failure	1-3-5
Zone anti-mask (transparency or proximity)	1-2-3-5
Zone anti-mask (dirty lens)	1-2-3-5

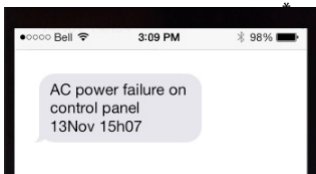

Information Index

- 1: Date and Time
- 2: Area Name
- 3: Zone / User / Module Name
- 4: ID
- 5: Module Serial Number

Trouble Restore Messages

Message	Information*
AC power restored on control panel	1
Battery power restored on control panel	1
Bell restored on control panel	1
Bell connected on control panel	1
Phone line restored on control panel	1
Central station communication from control panel restored	1-4
Date and time restored on control panel	1
System wireless communication restored	1
Tamper restored on module	1-3-5
Phone line restored on module	1-3-5
Central station communication from module restored	1-3-5
Printer module restored	1-3-5
AC power restored on bus or wireless module	1-3-5
Battery power restored on bus or wireless module	1-3-5
Auxiliary power restored on bus module	1-3-5
Missing module restored	1-3-5
Tamper restored on module	1-2-3-5
Fire zone restored	1-2-3-5
Battery on wireless zone restored	1-2-3-5
Wireless zone restored	1-2-3-5
Auxiliary power restored on control panel	1
Communication with GSM network restored	1
GSM communication with control panel restored	1
GSM/GPRS module: SIM card # connectivity restore	1
GSM/GPRS module: Tamper Restore	1
GSM/GPRS module: SIM card # connectivity restore	1
SIM Card initializing, please try again in # minutes	1
Trouble on module - direct light restore	1-3-5
Trouble on module - bus voltage trouble restore	1-3-5
Trouble on module - self-test failure restore	1-3-5
Zone anti-mask (transparency or proximity) restore	1-2-3-5
Zone anti-mask (dirty lens) restore	1-2-3-5

UC300 Messages

If your PCS250 is connected to an UC300 Universal Converter, the SMS messages will be different from non-connected units. The following table lists all pre-defined text messages that can be sent. These messages follow the 8-bit or 16-bit SMS protocol and include the elements from the information column. The messages will also use the labels programmed in the system for the area name, zone name, user name, and module name.

UC300 Alarm Messages

Message	Information*
Medical alarm	1-2-3
Personal emergency alarm	1-2-3
Fail to report in	2-3
Fire alarm	1-2-3
Smoke alarm	1-2-3
Combustion alarm	1-2-3
Water Flow alarm	1-2-3
Heat alarm	1-2-3
Pull Station alarm	1-2-3
Duct alarm	1-2-3
Flame alarm	1-2-3
Near alarm	1-2-3
Panic alarm	1-2-3
Duress alarm	1-2-3
Silent alarm	1-2-3
Audible alarm	1-2-3
Duress - access granted alarm	1-2-3
Duress - egress granted	1-2-3
Burglar alarm	1-2-3
Perimeter alarm	1-2-3
Interior alarm	1-2-3
24 Hr. alarm	1-2-3
Entry/Exit alarm	1-2-3
Day/Night alarm	1-2-3
Outdoor alarm	1-2-3
Tamper alarm	1-2-3
Near alarm	1-2-3
Intrusion verifier alarm	2-3
General alarm	2-3
Polling loop open alarm	2-3
Polling loop short alarm	2-3
Sensor tamper	1-2-3
Expansion module failure alarm	2-3
Silent burglary	1-2-3
Sensor supervision failure alarm	1-2-3

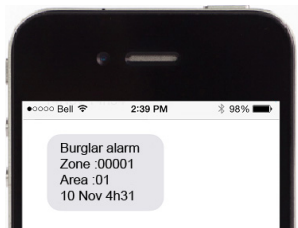

Information Index
 1: Zone / User
 2: Area
 3:Date and Time

UC300 Arming/Disarming Messages

Message	Information*
Arm/disarm	2-3
Arm/disarm by user	1-2-3
Group arm /disarm	2-3
Automatic arm /disarm	2-3
Remote arm/disarm	2-3
Quick arm/disarm	2-3
Keyswitch arm/disarm	1-2-3
Stay arm/disarm	2-3
Keyswitch stay arm/disarm	2-3
Exception arm /disarm	1-2-3
Early arm /disarm	1-2-3
Late arm /disarm	1-2-3
Re-arm after alarm arm /disarm	2-3



Information Index

1: Zone / User

2: Area

3:Date and Time

UC300 Trouble Messages

Message	Information*
24 Hr. non-burglary	1-2-3
Gas detection	1-2-3
Refrigeration	1-2-3
Loss of heat	1-2-3
Water leakage	1-2-3
Foil break	1-2-3
Day trouble	1-2-3
Low bottled gas level	1-2-3
High temp	1-2-3
Low temp	1-2-3
Loss of air flow	1-2-3
Carbon monoxide detected	1-2-3
Tank level	1-2-3
Fire supervisory	1-2-3
Low water pressure	1-2-3
Low CO2	1-2-3
Gate valve sensor	1-2-3
Low water level	1-2-3

Message	Information*
Pump activated	1-2-3
Pump failure	1-2-3
System trouble	2-3
AC loss	2-3
Low system battery	2-3
RAM checksum bad	2-3
ROM checksum bad	2-3
System reset	2-3
Panel program changed	2-3
Self-test failure	2-3
System shutdown	2-3
Battery test failure	2-3
Ground fault	2-3
Battery missing/dead	2-3
Power supply over current	2-3
Engineer reset	2-3
Sounder/Relay troubles	2-3
Bell 1	2-3
Bell 2	2-3
Alarm relay	2-3
Trouble relay	2-3
Reversing relay	2-3
Notification appliance ckt. #3	2-3
Notification appliance ckt. #4	2-3
System peripheral troubles	2-3
Polling loop open	2-3
Polling loop short	2-3
Expansion module failure	2*-3
Repeater failure	2-3
Local printer paper out	2-3
Local printer failure	2-3
Expansion module DC loss	1-2-3
Expansion module low battery	2-3
Expansion module reset	1-2-3
Expansion module tamper	2*-3
Expansion module AC loss	2-3
Expansion module self-test fail	1-2-3
RF receiver jam detect	2-3
Communication troubles	2*-3
Telco 1 fault	2*-3
Telco 2 fault	2-3
Long range radio	2-3
Fail to communicate	2*-3
Loss of radio supervision	2-3
Loss of central polling	2*-3
Long range radio VSWR problem	2-3
Protection loop trouble	2-3

Message	Information*
Protection loop trouble	2-3
Protection loop open	2-3
Protection loop short	2-3
Fire trouble	2-3
Exit error alarm (zone)	2-3
Panic zone trouble	1-2-3
Hold-up zone trouble	1-2-3
Swinger trouble	1-2-3
Cross-zone trouble	1-2-3
Sensor trouble	1-2-3
Loss of supervisory - FR	1-2-3
Loss of supervisory - RPM	1-2-3
Sensor tamper	1-2-3
RF transmitter low battery	1-2-3
Smoke detector high sensitivity	1-2-3
Smoke detector low sensitivity	1-2-3
Intrusion detector high sensitivity	1-2-3
Intrusion detector low sensitivity	1-2-3
Sensor self-test failure	1-2-3
Sensor watch trouble	1-2-3
Drift compensation error	1-2-3
Maintenance alert	1-2-3
Late to open	2-3
Late to close	2-3
Auto-arm failure trouble	2-3
Partial arm trouble	2-3
Exit error	1-2-3
User on premises	1-2-3
Recent close	2-3
Wrong code entry	2-3
Legal code entry	2-3
Auto-arm time extended trouble	1-2-3
Panic alarm reset	2-3
Service on / off premises	2-3



Information Index

1: Zone / User

2: Area

3:Date and Time

*: *Module ID will be reported.*

UC300 Trouble Restore Messages

Message	Information*
24 Hr. non-burglary restore	1-2-3
Gas detection restore	1-2-3
Refrigeration restore	1-2-3
Loss of heat restore	1-2-3
Water leakage restore	1-2-3
Foil break restore	1-2-3
Day trouble restore	1-2-3
Low bottled gas level restore	1-2-3
High temp restore	1-2-3
Low temp restore	1-2-3
Loss of air flow restore	1-2-3
Carbon monoxide detected restore	1-2-3
Tank level restore	1-2-3
Fire supervisory restore	1-2-3
Low water pressure restore	1-2-3
Low CO2 restore	1-2-3
Gate valve sensor restore	1-2-3
Low water level restore	1-2-3
Pump activated restore	1-2-3
Pump failure restore	1-2-3
System trouble restore	2-3
AC loss restore	2-3
Low system battery restore	2-3
RAM checksum bad restore	2-3
ROM checksum bad restore	2-3
System reset restore	2-3
Panel program changed	2-3
Self-test failure restore	2-3
System shutdown restore	2-3
Battery test failure restore	2-3
Ground fault restore	2-3
Battery missing/dead restore	2-3
Power supply over current restore	2-3
Engineer reset restore	2-3
Sounder/Relay troubles restore	2-3
Bell 1 restore	2-3
Bell 2 restore	2-3
Alarm relay restore	2-3
Trouble relay restore	2-3
Reversing relay restore	2-3
Notification appliance ckt. #3 restore	2-3
Notification appliance ckt. #4 restore	2-3
System peripheral troubles restore	2-3
Polling loop open restore	2-3
Polling loop short restore	2-3

Message	Information*
Expansion module failure restore	2*-3
Repeater failure restore	2-3
Local printer paper out restore	2-3
Local printer failure restore	2-3
Expansion module DC loss restore	1-2-3
Expansion module low battery restore	2-3
Expansion module reset restore	1-2-3
Expansion module tamper restore	2-3
Expansion module AC loss restore	2-3
Expansion module self-test fail restore	1-2-3
RF receiver jam detect restore	2-3
Communication troubles restore	2*-3
Telco 1 fault restore	2*-3
Telco 2 fault restore	2-3
Long range radio restore	2-3
Fail to communicate restore	2*-3
Loss of radio supervision restore	2-3
Loss of central polling restore	2*-3
Long range radio VSWR problem restore	2-3
Protection loop trouble restore	2-3
Protection loop trouble restore	2-3
Protection loop open restore	2-3
Protection loop short restore	2-3
Fire trouble restore	2-3
Exit error alarm (zone) restore	2-3
Panic zone trouble restore	1-2-3
Hold-up zone trouble restore	1-2-3
Swinger trouble restore	1-2-3
Cross-zone trouble restore	1-2-3
Sensor trouble restore	1-2-3
Loss of supervisory - FR restore	1-2-3
Loss of supervisory - RPM restore	1-2-3
Sensor tamper restore	1-2-3
RF transmitter low battery restore	1-2-3
Smoke detector high sensitivity restore	1-2-3
Smoke detector low sensitivity restore	1-2-3
Intrusion detector high sensitivity restore	1-2-3
Intrusion detector low sensitivity restore	1-2-3
Sensor self-test failure restore	1-2-3
Sensor watch trouble restore	1-2-3
Drift compensation error restore	1-2-3
Maintenance alert restore	1-2-3
Late to open restore	2-3
Late to close restore	2-3
Auto-arm failure trouble restore	2-3
Partial arm trouble restore	2-3
Exit error restore	1-2-3

Message	Information*
User on premises	1-2-3
Recent close	2-3
Wrong code entry	2-3
Legal code entry	2-3
Auto-arm time extended trouble	1-2-3
Panic alarm reset	2-3
Service on / off premises	2-3



Information Index

1: Zone / User

2: Area

3:Date and Time

*: *Module ID will be reported.*

Chapter 9: Troubleshooting

This chapter describes some basic issues that may occur on your PCS250G. It is not intended to be a complete guide for all possible issues. If you have tried the possible solutions provided below and are still experiencing technical issues, contact your installer.

Symptom	Solution(s)
No LEDs lit; no signs of operation	<ul style="list-style-type: none">• Check cable connections• Check power status
Unit cannot be accessed remotely by remote access software	<ul style="list-style-type: none">• Check accuracy and spelling of access commands (e.g., IP port, IP address, etc.)• Check GPRS service status (SIM card LED should be steady green or flashing green quickly)• System may be busy reporting events (quick green flashing of SIM card LED), wait and retry• Check power status of panel• Ensure the SIM card supports SMS services
No execution of SMS commands	<ul style="list-style-type: none">• Ensure the command is correct, as well as the password• System may be busy reporting events, wait and retry• Ensure the SIM card supports SMS services• Check GPRS service status (SIM card LED should be steady green or flashing green quickly)• Check cable interconnections• Check power status of panel
No SMS reporting	<ul style="list-style-type: none">• Ensure panel is configured for SMS reporting• Ensure the SIM card supports SMS services
GPRS reporting not successful after first attempt	<ul style="list-style-type: none">• Check GPRS service status (SIM card LED should be steady green or flashing green quickly)• Ensure the panel is properly configured to work with the IPR512 receiver or IPRS-7 software

Index

A	
Access Point Name	18
Alarm Messages	35, 39
Antenna Extension.....	15
Antenna Specifications	9
APN	
password	18
user name	18
Arm/Disarm	
messages	36
Arm/Disarm via Text Message	26
B	
BabyWare	29
BabyWare Access.....	20
BabyWare access	17
Backup reporting	22
Bandwidth saver mode	17
C	
Cancel SMS	34
Communicating Using Text Messages	17
Compatibility	5
Configuring the PCS250G	17
Consumption	9
Control panel	4, 8, 10, 11, 18, 21
presence	31
reporting events	24
D	
Digiplex EVO	32, 34
Dimensions	9
Disarming messages	36, 40
Domain name	28
Dual SIM card	8
E	
Encryption.....	9
End-user SMS programming	32
Event Call Options	33
EVO	20, 21, 24
EVO Series	22
EVO192	5
External power input	14
F	
Firmware upgrades	30

Forwarding SMS Messages 18

G

GPRS 11, 24

channel 22

LED feedback 7

network 18

remote access 27

reporting 20

Ground 14

GSM

cell phone network 31

network connection loss 31

GSM/GPRS modem 22

I

Included Items 5

Internet failure 22

IP Address 33

IP Port 33

IPRS12 GPRS/IP Monitoring Receiver 24

IPRS-7 22

K

K641 5

K641+ 5

K641R 5

Knockout holes 15

L

Labels 35, 38

Languages 25

LED 6

LED Feedback 7

Light-emitting diodes. See LED

List of SMS commands 27

Loss of GSM service 31

M

Master Programming 32

MG Series 5

MG Series 5

MG/SP / E-Series 20, 21, 32, 34

Module supervision 31

N

NEware 29

O

Operating Temperature 9

P	
PCS250G	
communication loss	7
configuration	17
LED feedback	7
overview	6
specifications	9
Phone number	27, 29, 32, 33
Power input	9
Power supply	14
connections	14
Pre-defined text messages	35, 38
Private Network	30
Programming phone numbers	18
Provider redundancy	8
Public Network	29

R	
Receiver settings	21
Receiving Text Messages	18
Registration parameters	18
Remote access	20
Required/Optional Items	5
Reset	27
Rod antenna	15

S	
Serial cable connector	11
Serial port	12, 24
Signal strength	27
LED feedback	7
SIM card	7, 8, 17
connection	10
installation	10
socket	30
SIM card 1	
LED feedback	7
SIM card 2	
LED feedback	7
SMS	
backup reporting	22
commands	18, 27
languages	25
messages	31
phone number special characters	33
text message format	26
SMS commands	
APN	27

APN password	27
APN user	27
arm/disarm	28
clear APN	27
clear domain name	28
disable bandwidth saver mode	27
enable bandwidth saver mode	27
GPRS remote access	27
IP address	27
reset PCS250G	27
set domain name	28
signal strength	27
view APN	28
SMS messages	
Language	25
SMS Protocol Specifications	9
SP Series	5, 22
Specifications	9
Supervision	31
System Components	6
System features	4
T	
Tamper switch	6, 8
TCP/IP password	29
Technical specifications	9
Text message notification	24
Text Messages	17
Text messages 35, 38	
Trouble	24
Trouble event messages	37, 40, 43
Trouble restore messages	38
U	
UC300	13
UC300 Connection	13
UC300 SMS messages	38
UC300 text messages	38
Upload/download	29, 30
User PC Software Password	33
V	
Viewing GPRS IP information	34
VSMS command	23
W	
Wait for call	30
Weight	9
Wire length	14

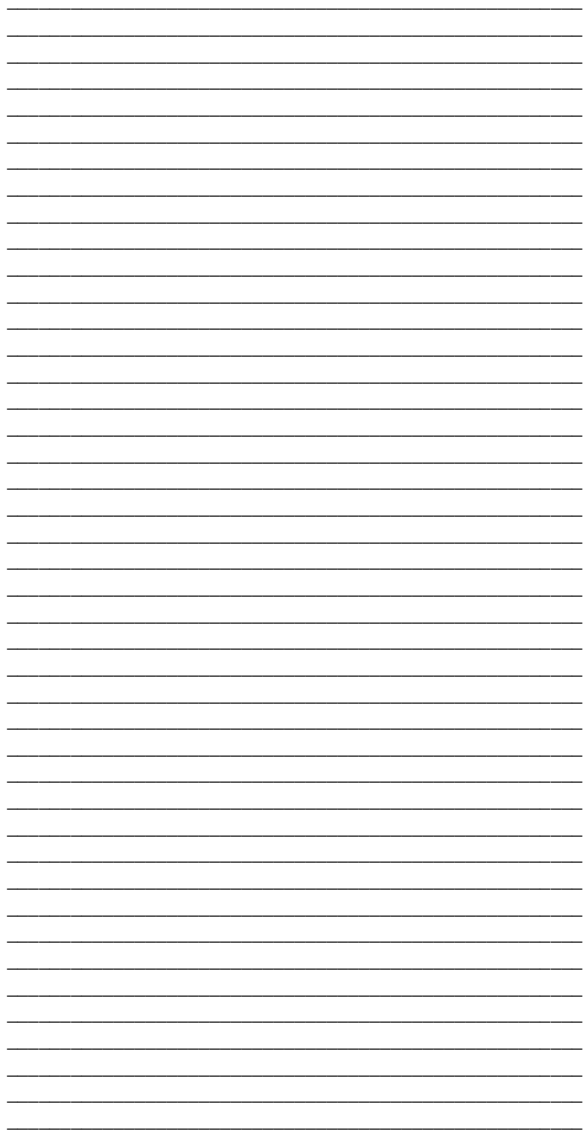

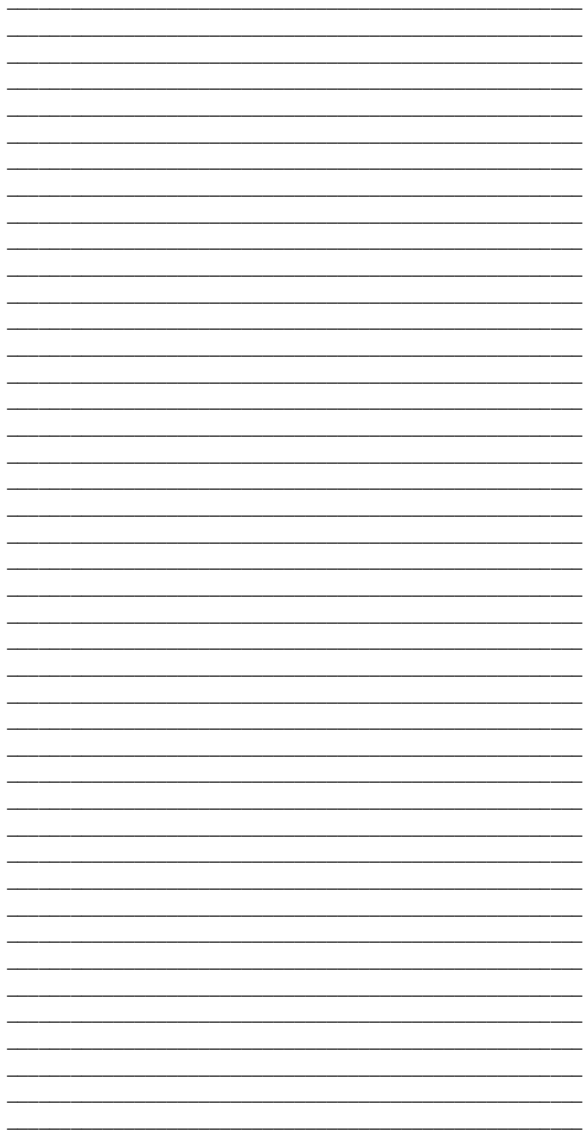

Warranty

For complete warranty information, please visit www.paradox.com/terms. Your use of the Paradox product signifies your acceptance of all warranty terms and conditions. Paradox, Spectra, EVO, Digiplex and BabyWare are trademarks or registered trademarks of Paradox Security Systems (Bahamas) Ltd. or its affiliates in Canada, the United States and/or other countries. For the latest product approvals, such as UL and CE, please visit www.paradox.com.

© 2014 Paradox Security Systems Ltd. All rights reserved.
Specifications may change without prior notice.

Patents

One or more of the following US patents may apply: 7046142, 6215399, 6111256, RE40650, 5920259, 5886632, 5571803 and RE39406 and other pending patents may apply. Canadian and international patents may also apply.

Additional Considerations

Annual verification of timing of an alarm and a fault message is required. AT55 requirements is the arithmetic mean of all transmissions is less than or equal to 20 seconds and 95% of all transmissions are less than or equal to 30 seconds. Time is measured from the moment the message is reported on a local keypad to when the monitoring station receiver successfully receives the message. This can be accomplished by contacting the monitoring station and sending a text message and calculating the time from which the message appears on the local keypad and when the monitoring station receives the same message.

As with traditional land-line reporting an acknowledgement (kiss-off) signal is used when the IP150 or PCS250G sends a valid message to a receiver that is typically used in a monitoring station. This acknowledgement is generated within 5 seconds.

Discuss with your service provider the different options that are available for monitoring; for example, the frequency of supervision.

The transmission of an alarm message may be negatively affected by a variety of factors. These may include disruptions in 3rd party services like internet access and GSM service. If after a set amount of transmission attempt are unsuccessful local and remote messages are generated.

Standard set of commonly available hand tool are require to install equipment; no equipment adjustments are necessary. When configured as indicated the PCS250G surpass the AT55 performance criteria set out in EN 50131-1.

For certified Paradox distributors:

For technical support in Canada or the U.S., call 1-800-791-1919,
Monday to Friday from 8:00 a.m. to 8:00 p.m. EST.

For technical support outside Canada and the U.S.,
call 00-1-450-491-7444, Monday to Friday from
8:00 a.m. to 8:00 p.m. EST.

To learn more about the complete line of Paradox products,
please visit www.paradox.com.